

# FIXED MANUAL RAMP

## Model CR



CR MANUAL RAMP has many advantages:

- It doesn't occupy space inside the bay and it's easy to handle.
- Thanks to its aluminum extruded structure, this ramp is good-looking and strong, totally rust-free.
- It is easy to install and cheaper than hydraulic ramps
- It can be easily moved through a chord.

Optional:

- **45-90° beveled lip on last 120mm**
- **L-shaped screwable plate 150x250mm for fixing**
- **Flat lip for small wheeled vehicles, ONLY FOR 0 OR NEGATIVE DIFFERENCES OF HEIGHT**

### TECHNICAL DETAILS

NOMINAL LENGTH*	400/600/800mm
NOMINAL WIDTH*	1250/1650/2000 mm
CAPACITY	40 kN (4T)
PLATE+LIP	H40mm aluminium extruded profiles
MAX. CONCENTRATED LOAD ON PLATFORM	1,3 N/mm <sup>2</sup>
ACTIVATION	Pvc coated steel handling chord
SAFETY	Vertical anti-falling side block

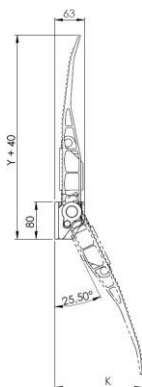
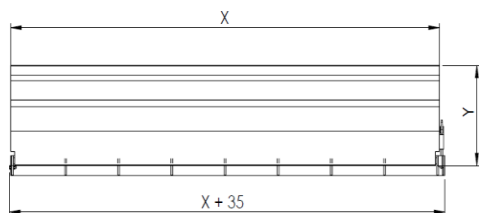

CODE	X mm	Y mm	H+/-	WEIGHT (Kg)
CR40S	1250	400	50	17
CR60S	1250	600	75	24
CR80S	1250	800	100	33
CR40A	1650	400	50	20
CR60A	1650	600	75	30
CR80A	1650	800	100	35
CR40B	2000	400	50	25
CR60B	2000	600	75	30

## FIXED MANUAL RAMP ACCESSORIES

### WALL SCREWING ANGULAR PROFILE L150.250.2500-5

Wall screwing 150x250mm angular profile with 5mm thickness and 2500mm length is **necessary for installation of manual fixed ramps or miniramps to loading bay corners with NO METAL PROFILE OR TOO LITTLE PROFILE OR DAMAGED PROFILE for fixing.**

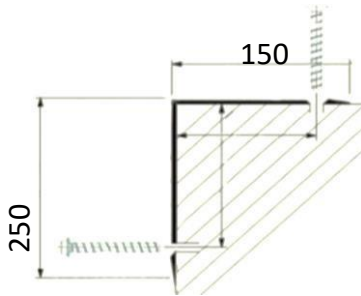

LENGTH 2500MM

### EXT Protection and distancing side structures (CR-GAS)

Protection and distancing side structures type EXT, made of GALVANIZED STEEL PROFILES with variable width (see images below), can ensure **FASTER AND SAFER TRUCK PARKING**, as they can let vehicle stay at the right position to lay down the lip onto the truckfloor



EXT  
120MM



EXT2  
240MM

### Side protection handrails for EXT structures (CR-GAS)

PPT galvanized steel side protection handrails, with H1100mm and h100mm TOEBOARD, combined with side protection EXT structures, can **prevent from any side falling danger on CR-GAS ramp**

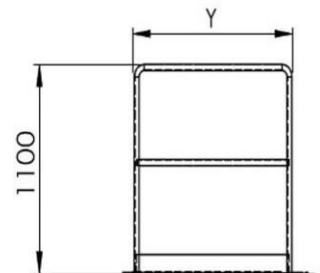

Y --> L EXT

## SLIDING MANUAL RAMP ACCESSORIES: SLIDING RAILS

### GF GALVANIZED STEEL RAILS TO BE WELDED TO PRE-EXISTING PROFILE

Galvanized steel rails are engineered to be directly SCREWED TO AN EXISTING H160MM PROFILE WITH TANGS INSIDE CONCRETE, not included in supply and to be previously cast inside concrete during building operations.

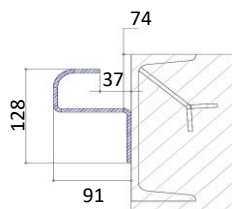

TR.GF3000  
FOR TR/TRR

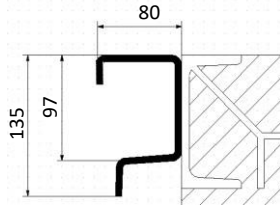

GAS.GF3000  
FOR GAS/ES

### GA ALUMINUM ANGULAR RAILS TO BE SCREWED TO CONCRETE

Aluminum angular rails can be directly LAID AND SCREWED ONTO CONCRETE CORNERS (WITH SCREWS INCLUDED IN SUPPLY), they're the perfect choice in case of absence of metal profiles or in case they were too small for the steel rails.

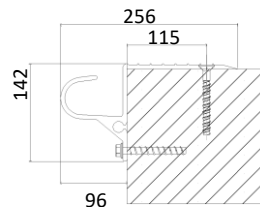

TR.GA3000  
FOR TR/TRR

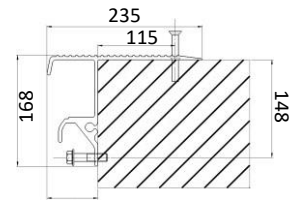

76  
GAS.GA3000  
FOR GAS/